



**BOARD OF
SUPERVISORS
SPECIAL
MEETING**

May 10, 2023

7:00pm: Special Business Meeting

Members present:

Mr. Frey	_____
Mr. Harrison	_____
Mrs. Hollibaugh	_____
Mr. Smullin	_____
Mrs. Jordan	_____

West Deer Township Board of Supervisors
May 10, 2023

7:00pm: Special Business Meeting

1. Call to Order
2. Pledge of Allegiance
3. Roll Call
4. Comments from the Public
5. Award: Municipal Building Project
 - A. Building Construction
 - B. HVAC Construction
 - C. Plumbing Construction
 - D. Electrical Construction
6. Award: Municipal Building Financing
7. Appointment: Clerk of the Works
8. Appointment: Geotechnical Engineer
9. Appointment: Testing and Balancing Agent
10. Authorization: Duquesne Light Temporary and Permanent Service
11. Other Business
12. Adjournment

1 Call to Order

2 Pledge of Allegiance

3 Roll Call

— Mr. Mator

COMMENTS FROM THE PUBLIC

THE BOARD WILL HEAR COMMENT ON AGENDA AND PUBLIC-RELATED ITEMS AT THIS TIME. PLEASE APPROACH THE MICROPHONE, CLEARLY STATE YOUR NAME AND ADDRESS, AND LIMIT YOUR COMMENTS TO FIVE (5) MINUTES.

5

AWARD: MUNICIPAL BUILDING PROJECT

PLANS, SPECIFICATIONS, AND BID DOCUMENTS WERE PREPARED BY HHSDR ENGINEERING FOR THE MUNICIPAL BUILDING PROJECT.

THE PROJECT WAS ADVERTISED, AND SEALED BIDS WERE RECEIVED UNTIL 11:00 A.M. ON THURSDAY, MAY 4, 2023, AT WHICH TIME THEY WERE OPENED AND READ ALOUD.

HHSDR IS REPRESENTED THIS EVENING BY MR. MATT FRANZ AND MR. DAVID KENT.

MR. FRANZ....

BEFORE THE BOARD VOTES ON THE CONSTRUCTION OF THE BUILDING, IT IS IMPORTANT TO UNDERSTAND THE FUNDING OF THE PROJECT, AS THE TWO ARE INTERTWINED.

THE TOWNSHIP RETAINED PUBLIC FINANCIAL MANAGEMENT (PFM) AS ITS FINANCIAL ADVISOR, AND DINSMORE & SHOHL, LLP AS BOND COUNSEL.

PFM IS REPRESENTED THIS EVENING BY MR. GARRETT MOORE, AND DINSMORE SHOHL IS BEING REPRESENTED BY MR. SEAN GARIN.

MR. MOORE AND MR. GARIN....

5A

CONTRACT NO. 1 - GENERAL CONSTRUCTION

WHAT ACTION DOES THE BOARD WISH TO TAKE.

I MOVE TO AWARD THE MUNICIPAL BUILDING PROJECT GENERAL
CONSTRUCTION CONTRACT TO DIMARCO CONSTRUCTION
COMPANY IN THE AMOUNT OF \$6,530,000.00.

	MOTION	SECOND	AYES	NAYES
MR. FREY	_____	_____	_____	_____
MR. HARRISON	_____	_____	_____	_____
MRS. HOLLIBAUGH	_____	_____	_____	_____
MR. SMULLIN	_____	_____	_____	_____
MRS. JORDAN	_____	_____	_____	_____

**BID TABULATION
NEW MUNICIPAL BUILDING
FOR
WEST DEER TOWNSHIP
HHSDR #4563**

MAY 4, 2023

GENERAL CONSTRUCTION CONTRACT NO. 1			
	Base Bid	Alt. G-1 (-)	Alt.G-2 (+/-)
DiMarco Construction Company Clairton, PA	\$ 6,530,000	\$ (234,000)	\$ (27,000)
Waller Corporation Washington, PA	\$ 6,749,800	\$ (191,400)	\$ (26,500)
Caliber Contracting Cheswick, PA	\$ 7,094,000	\$ (208,000)	\$ (29,000)
Hudson Group Hermitage, PA	\$ 7,718,000	\$ (235,000)	\$ (27,000)
Graham Construction Claysville, PA	No Bid Submitted		
Hudson Construction Hermitage, PA	No Bid Submitted		
TBI Contracting McKeepport, PA	No Bid Submitted		

Alt. G-1 Deduct covered police parking canopy.

Alt. G-2 Add to or deduct from asphalt roof shingles in lieu of standing seam metal roofing.

5B

CONTRACT NO. 2 - HVAC CONSTRUCTION

WHAT ACTION DOES THE BOARD WISH TO TAKE.

I MOVE TO AWARD THE MUNICIPAL BUILDING PROJECT HVAC CONTRACT TO FIRST AMERICAN INDUSTRIES, INC. IN THE AMOUNT OF \$1,364,000.00.

	MOTION	SECOND	AYES	NAYES
MR. HARRISON	_____	_____	_____	_____
MRS. HOLLIBAUGH	_____	_____	_____	_____
MR. SMULLIN	_____	_____	_____	_____
MR. FREY	_____	_____	_____	_____
MRS. JORDAN	_____	_____	_____	_____

**BID TABULATION
NEW MUNICIPAL BUILDING
FOR
WEST DEER TOWNSHIP
HHSDR #4563**

MAY 4, 2023

HVAC CONSTRUCTION CONTRACT NO. 2	
	Base Bid
First American Industries, Inc. Pittsburgh, PA	\$ 1,364,000
East West Manufacturing and Supply, Inc. Pittsburgh, PA	\$ 1,380,000
Lugaila Mechanical, Inc. Pittsburgh, PA	\$ 1,449,500
D & G Mechanical West Middlesex, PA	\$ 1,469,000
R & B Mechanial, Inc. Pittsburgh, PA	\$ 1,498,000
Renick Brothers Slippery Rock, PA	\$ 1,545,000
Hranec Corporation Uniontown, PA	\$ 1,635,500

50

CONTRACT NO. 3 - PLUMBING CONSTRUCTION

WHAT ACTION DOES THE BOARD WISH TO TAKE.

I MOVE TO AWARD THE MUNICIPAL BUILDING PROJECT PLUMBING CONTRACT TO VRABEL PLUMBING COMPANY, LLC IN THE AMOUNT OF \$538,200.00.

	MOTION	SECOND	AYES	NAYES
MRS. HOLLIBAUGH	___	___	___	___
MR. SMULLIN	___	___	___	___
MR. FREY	___	___	___	___
MR. HARRISON	___	___	___	___
MRS. JORDAN	___	___	___	___

**BID TABULATION
NEW MUNICIPAL BUILDING
FOR
WEST DEER TOWNSHIP
HHS DR #4563**

MAY 4, 2023

PLUMBING CONSTRUCTION NO. 3	
	Base Bid
Vrabel Plumbing Company, LLC Gibsonia, PA	\$ 538,200
Renick Brothers Slippery Rock, PA	\$ 640,000
First American Industries, Inc. Pittsburgh, PA	\$ 693,450
Wheels Mechanical Contracting Elrama, PA	\$ 697,640
McRandal Company, Inc. Pittsburgh, PA	\$ 852,200
Independence Excavating, Inc. Independence, Ohio	No Bid Submitted
Reno Brothers, Inc. New Brighton, PA	No Bid Submitted

5D

CONTRACT NO. 4 – ELECTRICAL CONSTRUCTION

WHAT ACTION DOES THE BOARD WISH TO TAKE.

I MOVE TO AWARD THE MUNICIPAL BUILDING PROJECT ELECTRICAL CONTRACT TO MERIT ELECTRICAL GROUP, INC IN THE AMOUNT OF \$1,324,000.00.

	MOTION	SECOND	AYES	NAYES
MR. SMULLIN	_____	_____	_____	_____
MR. FREY	_____	_____	_____	_____
MR. HARRISON	_____	_____	_____	_____
MRS. HOLLIBAUGH	_____	_____	_____	_____
MRS. JORDAN	_____	_____	_____	_____

**BID TABULATION
NEW MUNICIPAL BUILDING
FOR
WEST DEER TOWNSHIP
HHS DR #4563**

MAY 4, 2023

ELECTRICAL CONSTRUCTION NO. 4			
	Base Bid	Alt. E-1 (-)	Alt. E-2 (+/-)
Uzmack Electric, Inc. * Saxonburg, PA	\$ 959,000	(+/-)210	(+/-) 30000
Merit Electrical Group, Inc. Oakmont, PA	\$ 1,324,000	\$ (3,500)	\$ (60,000.00)
Allegheny City Electric, Inc. Pittsburgh, PA	\$ 1,417,000	(+) 3,500	\$ (5,000.00)
Schultz Electric, Inc. Washington, PA	\$ 1,498,568	\$ (1,700)	\$ (8,500.00)
Right Electric, Inc. Butler, PA	\$ 1,677,777	(+) 4,800	\$ (28,000.00)
A-1 Electric, Inc. Washington, PA	\$ 1,698,000	\$ (3,500)	\$ (72,000.00)
Turik's Electric, LLC Herminie, PA	No Bid Submitted		
Miller Company Electrical Contractors Uniontown, PA	No Bid Submitted		

Alt. E-1 Deduct site lighting associated with the covered police parking canopy (Alt Bid G-1).

Alt. E-2 Add or Deduct substitution of MC cable in lieu of pipe conduit for branch circuit wiring.

* Bidder withdrew bid due to mathematical error.



Uzmack Electric, Inc.
Box 552
Saxonburg, PA 16056

Daniel Mator
Township Manager,
West Deer Township

I am requesting to withdraw my bid due to a numerical error in the final Bid Price.
Sorry for the inconvenience this may have caused.

Thank you

Dale Uzmack
Uzmack Electric, Inc

5/05/2023

6

AWARD: MUNICIPAL BUILDING FINANCING

THE BOARD OF SUPERVISORS RECEIVED DOCUMENTS UNDER SEPARATE COVER CONTAINING MULTIPLE FUNDING OPTIONS FROM PFM, AND WILL BE RECEIVING A SPECIALIZED MOTION AT THE MEETING DEPENDING ON THEIR DECISION.

WHAT ACTION DOES THE BOARD WISH TO TAKE.

I MOVE TO...

	MOTION	SECOND	AYES	NAYES
MR. FREY	_____	_____	_____	_____
MR. HARRISON	_____	_____	_____	_____
MRS. HOLLIBAUGH	_____	_____	_____	_____
MR. SMULLIN	_____	_____	_____	_____
MRS. JORDAN	_____	_____	_____	_____

7

APPOINTMENT: CLERK OF THE WORKS

A CLERK OF THE WORKS SERVES AS A SORT OF CONSTRUCTION MANAGER FOR THE BUILDING PROJECT. THEY ACT AS THE EYES AND EARS OF THE TOWNSHIP, AND CONCENTRATE ON REPORTING ACTIVITIES ON THE PROJECT TO THE TOWNSHIP AND ARCHITECT.

POTENTIAL CONSTRUCTION MANAGERS AND CLERKS OF THE WORKS HAD BEEN CONTACTED, AND THE TOWNSHIP RECEIVED A REPLY FROM ROGER DUNLAP OR FREEDOM ENTERPRISES & ASSOCIATES. THEIR PROPOSAL IS ATTACHED.

MR. DUNLAP....

WHAT ACTION DOES THE BOARD WISH TO TAKE.

I MOVE TO APPOINT FREEDOM ENTERPRISES & ASSOCIATES AS THE CLERK OF THE WORKS FOR THE NEW MUNICIPAL BUILDING PROJECT AT A COST NOT TO EXCEED \$186,320.

	MOTION	SECOND	AYES	NAYES
MR. HARRISON	_____	_____	_____	_____
MRS. HOLLIBAUGH	_____	_____	_____	_____
MR. SMULLIN	_____	_____	_____	_____
MR. FREY	_____	_____	_____	_____
MRS. JORDAN	_____	_____	_____	_____

Roger H. Dunlap, dba Freedom Enterprises & Associates
est. 1994
171 Autumn Hill Dr. Cranberry Township, PA 16066
724.321.2655
rogerdunlap1201@gmail.com

28 April 2023

Mr. Daniel Mator
West Deer Township
109 East Union Road
Cheswick PA 15024

Reference: Clerk of the Works (REVISED)

Dear Mr. Mator,

We have estimated our services based on time, not a percentage of the final construction costs. We propose to provide all services as described in the attached RFP for the lump sum total amount not to exceed of: \$186,320 starting 6/1/2023 through 10/31/24. Freedom Enterprises will be compensated at a rate of \$10,960 per month for 17 months. (June 2023 through October 2024) This rate can be used to deduct if project is delayed and will be added if project duration requires additional services.

The proposed amount was derived from three weeks at 32 hours plus one week at 24 hours per month, plus one week unpaid and off the clock in July 2023, December 2023, July 2024. Further fine tuning could be added or deducted at a rate of \$680.00 per day.

We have specifically excluded: Printing, copying related to submittals, supplemental drawings or sketches; also E&O Insurance, we have included General Liability Insurance similar to most general contractors carry.

We would provide our 8x20 office trailer which we have used for the last 29 years, also at no cost to the owner, park it beside the other 4 (10 x 40) contractors trailers in the staging area north parking lot area. We will provide documentation from our office in Cranberry Township, until trailers can be mobilized, and observation from onsite, and attend any meetings at the existing township building.

We would like to be on board formally by 5/10/24, and from 5/4/23 through May 31 there would be no cost to the township, for any role we would play in the preconstruction phase. (so we would not be "on the clock" until 6/1/23). Or whatever the township deems an appropriate start date, due to final bid totals.

Thank you for the opportunity to provide our revised proposal and look forward to working with the township, the design professionals and the contractors.

Please contact me with any questions or comments.

Sincerely,

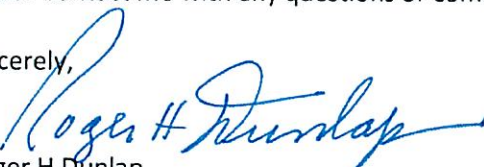

Roger H Dunlap
owner

8

APPOINTMENT: GEOTECHNICAL ENGINEER

AS PART OF THE CONSTRUCTION PROCESS OF THE NEW MUNICIPAL BUILDING, THE BOARD OF SUPERVISORS MUST RETAIN A GEOTECHNICAL ENGINEER TO PERFORM SPECIAL INSPECTIONS AND CONSTRUCTION TESTING SERVICES DURING CONSTRUCTION.

A PROPOSAL FROM PENNSYLVANIA SOIL & ROCK, INCORPORATED IS ATTACHED.

MR. FRANZ....

WHAT ACTION DOES THE BOARD WISH TO TAKE.

I MOVE TO APPOINT PENNSYLVANI SOIL AND ROCK, INCORPORATED AS THE TOWNSHIP'S GEOTECHNICAL ENGINEER TO PROVIDE SPECIAL INSPECTIONS AND CONSTRUCTION TESTING SERVICES AS PROPOSED.

	MOTION	SECOND	AYES	NAYES
MRS. HOLLIBAUGH	___	___	___	___
MR. SMULLIN	___	___	___	___
MR. FREY	___	___	___	___
MR. HARRISON	___	___	___	___
MRS. JORDAN	___	___	___	___

**PROPOSAL
SPECIAL INSPECTIONS & CONSTRUCTION TESTING SERVICES**

**WEST DEER TOWNSHIP
NEW MUNICIPAL BUILDING
WEST DEER TOWNSHIP, ALLEGHENY COUNTY, PENNSYLVANIA**

Prepared for:

**Mr. Daniel J. Mator, Jr.
Township Manager
West Deer Township
109 East Union Road
Cheswick, Pennsylvania 15024**

Prepared By:



PS&R Proposal No. 23-184

March 22, 2023

Pennsylvania Soil and Rock Incorporated

INDEX

- 1.0 Letter of Interest / General Qualifications
- 2.0 Company Organizational Chart / PS&R Key Staff Resumes
- 3.0 Certificate of Insurance
- 4.0 Professional Services and Laboratory Testing Unit Rates

Pennsylvania Soil and Rock Incorporated

1.0 Letter of Interest / General Qualifications / Proposal

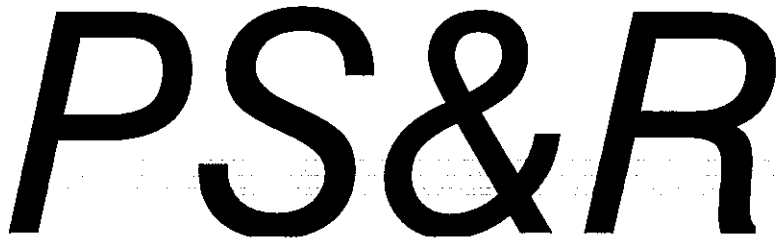

Pennsylvania Soil and Rock Incorporated

March 21, 2023

PS&R Proposal No. 23-184

Mr. Daniel J. Mator, Jr.
Township Manager
West Deer Township
109 East Union Road
Cheswick, Pennsylvania 15024

**RE: Proposal – Special Inspections and Construction Testing Services
West Deer Township – New Municipal Building
West Deer Township, Allegheny County, Pennsylvania**

Dear Mr. Mator:

This letter presents Pennsylvania Soil and Rock, Inc.'s (PS&R) proposal to provide Special Inspections and Construction Testing Services during the construction of the proposed new West Deer Township Municipal Building.

PS&R Qualifications

Based on the scope of anticipated inspection and testing requirements from our experience on similar size and usage projects, we feel that we are well suited to provide comprehensive on-site geotechnical consultation, field construction monitoring and special testing services and would be an asset to West Deer Township as well as the design / construction team. Furthermore, and as you are aware, myself and one of PS&R's Senior Field Technicians (Bob Beckett) are long time West Deer residents and have a personal interest in seeing to the completion of a successful project.

PS&R's current staff is made up of seven professional engineers, four professional geologists and one staff geologist, one professional land surveyor, one field services manager with nine experienced field technicians, one soil/concrete laboratory manager/professional

570 Beatty Road Monroeville, PA 15146 412-372-4000

Pennsylvania Soil and Rock Incorporated

West Deer Township Municipal Bldg

2

March 22, 2023

engineer with two staff laboratory technicians, one CADD operator/draftsman and several other office staff. With strong academic backgrounds and over 80 years of combined professional work experience, our engineers, geologists, field technicians and office staff are able to provide our clients with practical engineering and testing solutions for even the most demanding projects. We take great pride in providing our clients with innovative and cost-effective engineering solutions without compromising our high standards. By working closely with our clients, their designers and contractors, we are better able to understand their specific needs and can provide those services necessary for a successful project.

At PS&R we take great pride in providing quality professional consulting services at a competitive cost. Located approximately 25 minutes east of Pittsburgh, in Monroeville, Pennsylvania, PS&R has been providing Geotechnical Engineering, Construction Monitoring & Material Testing and Site Civil / Design Services to clients throughout Pennsylvania, Ohio and West Virginia for almost 40 years.

Some of our projects of similar size and scope of services include:

- Upper St Clair Recreation Center – Upper St Clair, PA
- Butler Memorial Hospital 7-Story Addition – Butler, PA
- Pivik Elementary School – Plum Borough, PA
- Holiday Park Elementary School – Plum Borough, PA
- The Highlands Sports Complex – Triadelphia, WV
- Plum Municipal Building – Plum Borough, PA

Background Information

As you are aware, PS&R previously coordinated and completed a Geotechnical Investigation and Infiltration Study for the proposed new Municipal Building Project. We have also reviewed the preliminary site grading / layout drawings for the project to aid in the development of this proposal. The proposed municipal building structure will be situated directly east of the existing municipal building, fronting along East Union Road. The majority of the site grading will occur east of the building footprint in order to install the proposed SW basin and northeast parking area.

The preceding discussion represents our understanding of the proposed project and is an important part of how we developed our proposed scope of work. If this understanding is not correct or if project plans have changed, we should be notified prior to authorizing the start of the field work.

Pennsylvania Soil and Rock Incorporated

West Deer Township Municipal Bldg

3

March 22, 2023

Scope of Work

We propose to provide a qualified field technician(s) on an as required, full to part-time basis to cover all applicable site work, utility installation and building construction activities as required. Our project managers and field staff will work closely with the site superintendent and/or site contractors to coordinate the necessity for our services at the site. *Since I personally will be acting as the project manager for this project, we will be able to provide immediate consultation if needed at reduced cost (no drive time / mileage to be invoice for project management / consultation services).* We will also utilize my local field technician as much as possible to also reduce travel time and mileage charges. Our field technicians will observe and document all site work and/or construction activities performed, note compliance or non-compliance with the project specifications and perform all applicable field testing as required. Any problems or non-compliance will be reported to the site superintendent and project engineer (PS&R) in order to rectify such occurrences, if any, in an appropriate and timely manner.

All work will be documented in a daily field report which will also include an annotated sketch indicating where the various work items were performed along with a summary of all field tests conducted that day. The technician will also collect fill material samples and cast concrete, masonry, mortar, and grout cylinders for laboratory testing as required. Our project engineer will review the daily reports and will then summarize and transmit the reports to you or as required. In addition, the project engineer or a staff engineer/geologist will be available to visit the site or attend site meetings as required.

Our services will be rendered on a unit cost basis, calculated using the unit rates included on the enclosed Rate Schedules. It should be noted that we do not invoice at a premium rate (1.5 x base rate) for time beyond 8 hours per work day, after 40 hours per week or for weekend work. Field time is billed on a portal-to-portal basis, including travel time and mileage, however we do not have a daily minimum show-up charge. All applicable testing equipment (except for Troxler densometer) and on-site testing is included in the field technician hourly rate, i.e. there are no additional per test charges for concrete slump, air, etc. or for each density test. There is a daily rental rate for the Troxler densometer, which is used to maintain our license through the Nuclear Regulatory Commission.

At this time it appears that West Deer Township may only be responsible for the geotechnical inspection and monitoring services (including fill compaction testing, foundation bearing verification and subgrade preparation confirmation). PS&R can also provide all aspects of building construction inspection / testing such as concrete testing, masonry testing, structural steel inspection, and subbase / asphalt testing whether it be for the Township or General Contractor. There will likely be many instances where numerous construction activities will be completed concurrently. Where practical, we can cover the various construction activities using one full-time technician. Additional field staff will be available for those times where the

Pennsylvania Soil and Rock Incorporated

West Deer Township Municipal Bldg

4

March 22, 2023

specifications require additional and/or more comprehensive monitoring and testing. Because a tentative construction schedule is yet to be developed, estimating a lump sum cost for a project of this magnitude is difficult. However, based on our experience with similar sized projects, we suggest allotting a budget of \$18,000 for the anticipated geotechnical inspections.

Comprehensive construction monitoring and testing services for all site work and building construction would likely be on the order of \$40,000. Our unit rate schedule is included with this proposal.

If you are in agreement with our proposed scope of services and costs, you may either issue a purchase order for this work or complete the attached Proposal Acceptance Agreement and return one complete copy to us for our files. We appreciate the opportunity to continue to provide our services to West Deer Township, and look forward to working with the design and construction team on the new Municipal Building Project. If you have any questions regarding this proposal, please do not hesitate to contact me at 412-372-4000.

Respectfully submitted,
Pennsylvania Soil and Rock, Inc.

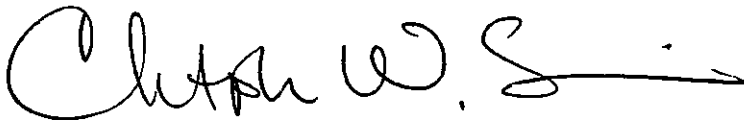
A handwritten signature in dark ink, appearing to read "Chris W. Samios", with a long horizontal flourish extending to the right.

Christopher W. Samios, P.E.
Principal / Project Manager

Pennsylvania Soil and Rock Incorporated

PROPOSAL ACCEPTANCE AGREEMENT

The Pennsylvania Soil and Rock, Inc. Proposal No. 22-184, dated March 22, 2023 and entitled, "Proposal – Special Inspections & Construction Testing Services, West Deer Township – New Municipal Building, West Deer Township, Allegheny County, Pennsylvania" is accepted. We agree to pay PS&R invoices for this work within 30 days of the invoice date. Any outstanding balance will be subject to 1.5- percent interest per month until it is retired.

By:

Name and Title: _____

Company: _____

Address: _____

Dated: _____

Signature: _____

Pennsylvania Soil and Rock Incorporated

2.0 Company Organizational Chart / PS&R Key Staff Resumes

PS&R

Pennsylvania Soil and Rock Incorporated

Company Organizational Chart

Company Managers

Arnold Caffas P.G.
President / Project Manager

Christopher Samios P.E.
V.P / Project Manager

Office Staff

Colleen Caffas
Controller

Brenda Samios
Administrative Assistant

Key Professional Staff

Shannon Yoder P.E.
Project Engineer

Dan Sanger P.G.
Project Geologist

Paul Fiset, P.E.
Lab Manager

Doug DiNardo
CADD Draftsman

Dave Irvine
Field Manager

Key Field Personnel

Bob Bechtold
Sr. Field Tech

Ben Rankin
Sr. Field Tech

Dave Irvine
Certified Steel Inspector

CHRISTOPHER W. SAMIOS, P.E.
Partner / Geotechnical Project Engineer

CAREER SUMMARY

Registered Professional Engineer with 25+ years of hands-on, practical experience in geotechnical engineering and consulting. Career began as a field engineer and laboratory technician, progressed to project engineer and engineering design, and then to project manager responsible for overseeing and coordinating with other engineers, design professionals, technicians, and contractors. Responsibilities also include geotechnical design, proposal and report preparation, development of cost estimates, project budgeting, marketing plans, client interaction, and overall business relations. Became partner and Vice President of Pennsylvania Soil & Rock, Inc. in January 2008.

PROFESSIONAL EXPERIENCE

January 2008 – Present Pennsylvania Soil & Rock, Inc. – Partner/Vice President

Responsibilities: Oversee and review all technical / engineering work for PS&R. Coordinate, oversee and manage geotechnical department, construction monitoring & testing services and concrete/soils testing laboratory. Develop and oversee all natural gas (Marcellus / Utica) industry geotechnical and construction monitoring services.

April 2004 – December 2007 Pennsylvania Soil & Rock, Inc. - Project Engineer/Manager

Responsibilities: Work scope and budget development for subsurface explorations and construction monitoring projects, proposal preparation, subsurface exploration report preparation and review, specification preparation and review, and supervision of field staff. Major areas of focus include: MSE wall design and review, slope stability, mine stabilization, and pavement forensics, design, and rehabilitation.

1997 – April 2004 EDP Consultants, Inc. - Project Engineer/Manager

Responsibilities: Work scope and budget development for subsurface explorations and construction monitoring projects, proposal preparation, subsurface exploration report preparation and review, specification preparation and review, supervision of field staff and problem solving during construction monitoring, maintaining client relations throughout projects, and reviewing billing and payment history for projects. Major areas of focus include: Subgrade stabilization, pavement evaluation, design, rehabilitation, and maintenance, foundation design and installation, and site improvement methods.

1995 – 1997 EDP Consultants, Inc. - Field Engineer and Laboratory Technician

Responsibilities: Construction material testing and inspection including; compaction testing of soils, field concrete testing, asphalt testing, monitoring subgrade stabilization and pavement recycling operations, high strength bolted and welded connections inspection, monitoring field quantities and work performed, and responsible for the training of field technicians. Duties also included field verification of foundation bearing surfaces and pavement subgrade stability, inspection of deep foundations, construction related groundwater control,

CHRISTOPHER W. SAMIOS, P.E.

evaluation of existing pavements, proof-rolling, and maintain client relations. Laboratory duties included laboratory testing of soils and concrete including; index properties of soils, triaxial and

unconfined compressions testing of soils, compression testing of concrete, consolidation and shrink-swell characteristics, Proctors, CBRs, asphalt and concrete mix designs, aggregate blending, and soil-cement mix designs.

EDUCATION

B.S. in Civil Engineering - The Pennsylvania State University 1994

M.S. in Civil Engineering (Foundations and Site Improvement) - The University of Akron 2002

ACCREDITATIONS & CERTIFICATIONS

Registered Professional Engineer (PE 66049) Ohio 2001

Registered Professional Engineer (PE 071046) Pennsylvania 2004

Registered Professional Engineer (PE 016516) West Virginia 2005

Member – American Society of Civil Engineers (ASCE)

ACI Level I Concrete Field Testing Certification

Radiological Safety & Use of Nuclear Testing Equipment, Troxler Corporation

CONTINUING PROFESSIONAL DEVELOPMENT

Soils Stabilization and Pavement Reclamation, Cleveland, Ohio 1998

OTEC Conference, Columbus, Ohio 1998

Design & Construction of Earth Retaining Structures, DFI, Cincinnati, Ohio 2000

Underground Utility Line Protection Safety Workshop, Grove City, PA 2000

Mechanically Stabilized Earth Retaining Walls Short Course, University of Akron, Ohio 2001

Concrete Pavement Engineering, NOCPC, Independence, Ohio 2002

Fundamentals of Project Management, ASFE, Columbus, Ohio 2003

Ohio LTAP Center, Asphalt Pavement Preservation Short Course, Cleveland, Ohio 2003

Stormwater Regulations & Innovations, Westmoreland Conservation Dist., PA 2005

Practical Best Management Practices, Westmoreland Conservation Dist., Greensburg, PA 2006

Direct Shear Testing/Slope Stability Issues Short Course, Geosynthetics 2007, Washington DC

ARRA In-Place Asphalt Recycling Seminar, Cuyahoga County/ARRA, Cleveland, Ohio 2007

PAAMA / PennDOT FDR Conference, State College, PA 2009

Your Business & Marcellus Shale, Indiana County, PA 2009

Shallow Foundation Design, Construction and Repair, Pittsburgh, PA 2014

Retaining Walls and Slope Stabilization Techniques, Pittsburgh, PA 2015

Managing Engineering Risks, Pittsburgh, PA 2016

SHANNON R. YODER, P.E.
Geotechnical Project Engineer

CAREER SUMMARY

Registered Professional Engineer with over 8 years of hands-on, practical experience in geotechnical engineering and consulting. Career began as a field engineer and laboratory technician, progressed to project engineer and engineering design, and then to project manager responsible for overseeing and coordinating with other engineers, design professionals, technicians, and contractors. Responsibilities also include geotechnical design, proposal and report preparation, development of cost estimates, project budgeting, marketing plans, client interaction and overall business relations.

PROFESSIONAL EXPERIENCE

February 2012 – Present Pennsylvania Soil & Rock, Inc. - Project Engineer, P.E.

Responsibilities: Serve as an on-site engineer, verifying construction practices and sequencing is properly implemented and documented. In addition, perform construction material testing and inspection, i.e. concrete testing and soil compaction testing; logging of boreholes during geotechnical drilling; infiltration testing; bearing capacity evaluations; and additional geotechnical field investigations. Project management including preparing, developing and presenting geotechnical analysis reports with the aid of geotechnical mapping and other necessary resources; development of geotechnical borings based on preliminary research; processing necessary laboratory testing; utilizing all investigation information and implementing into geotechnical site design. Geotechnical site design including slope stability analysis; retaining wall design and analysis; soil bearing capacity and foundation recommendations; mining and related subsidence and expansion remediation; groundwater analysis and remediation; cut and fill earthwork design and recommendations; pavement design and recommendations.

Summer 2010 & 2011 Pennsylvania Department of Transportation - Summer Intern

Responsibilities: Heavy highway construction inspection including; inspection of construction materials and process as prepared by specifications and drawings, measuring and documenting quantities and items used during construction and quality control, management of other summer interns during larger projects, highly independent working atmosphere from supervisors.

EDUCATION

B.S. in Civil Engineering - The Pennsylvania State University 2011

M.S. in Civil Engineering (Geotechnical Engineering) - The University of Pittsburgh 2015

ACCREDITATIONS & CERTIFICATIONS

Registered Professional Engineer (PE085657) Pennsylvania 2016, West Virginia and Ohio 2017

Member – American Society of Civil Engineers (ASCE)

Radiological Safety & Use of Nuclear Testing Equipment, Troxler Corporation

DANIEL B. SANGER, P.G.
Consulting Engineering Geologist

CAREER SUMMARY

Registered Professional Geologist with over 30 years of hands-on, practical experience in geotechnical engineering and consulting. Career began as a field engineer and laboratory technician, progressed to project geologist and project oversight. Responsibilities also include geotechnical design, proposal and report preparation, development of cost estimates and project budgeting.

PROFESSIONAL EXPERIENCE

October 2006 – Present Pennsylvania Soil & Rock, Inc. - Project Geologist/Manager

Responsibilities: Work scope and budget development for subsurface explorations and construction monitoring projects, proposal preparation, subsurface exploration report preparation and review, specification preparation and review, and supervision of field staff. Major areas of focus include: geotechnical exploration, slope stability, mine stabilization, and construction observation.

May 1987 – October 2006 GAI Consultants, Inc. - Geologist to Senior Geologist II

Responsibilities: Geotechnical field investigation/exploration, construction material testing and inspection including; compaction testing of soils, field concrete testing, asphalt testing, monitoring field quantities and work performed, and responsible for the training of field technicians. Duties also included field verification of foundation bearing surfaces and pavement subgrade stability, inspection of deep foundations, construction related groundwater control, evaluation of existing pavements, proof-rolling, and maintain client relations.

May 1983 – 1987 Park Ohio Energy - Exploration Geologist

EDUCATION

B.S. in Geology - S.U.N.Y. Brockport 1978

M.S. in Geology - The University of Akron 1983

ACCREDITATIONS & CERTIFICATIONS

Registered Professional Geologist, Arkansas 1989, Wyoming 1992, Pennsylvania 1995

Member – Association of Engineering Geologists (AEG), Pittsburgh Geological Society

PennDOT Level II Drilling Inspector

Radiological Safety & Use of Nuclear Testing Equipment, Troxler Corporation

SafeLandUSA Training, 2014, Chevron Safety Training

HAZWOPER Personal Protection and Safety Training in accordance with OSHA Standard 29

CFR 1910 and SARA Section 126(d). 40 Hour Training and Current 8 Hour Refresher

David L. Irvine
Field Services Manager

CAREER SUMMARY

Field Services Manager with over 15 years of hands-on, practical experience in construction consulting. Career began as a field and laboratory technician and progressed to field services manager responsible for overseeing and coordinating with technicians, engineers and contractors. Responsibilities also include supervision of field staff, scheduling, construction monitoring report review and periodic construction monitoring.

PROFESSIONAL EXPERIENCE

January 2014 – Present Pennsylvania Soil & Rock, Inc. - Field Services Manager

Responsibilities: Supervision of field staff, technician scheduling and training, construction monitoring, report preparation and review, periodic site visits as well as the procurement of project information for field staff. Major areas of focus include: Field Technician oversight and scheduling, construction monitoring, presumptive bearing evaluations and general coordination between field personnel, engineering staff and clients.

May 2005 – January 2014 Pennsylvania Soil & Rock, Inc. - Senior Field Technician

Responsibilities: Construction materials testing and inspection including; compaction testing of soils, field concrete testing, asphalt testing, monitoring subgrade stabilization, high strength bolted and welded connections inspection, masonry inspection, sprayed fireproofing inspection, sanitary and storm water system installation inspection, monitoring field quantities and work performed, and responsible for the training of field technicians. Duties also include field verification of foundation bearing surfaces and pavement subgrade stability, inspection of deep foundations, construction related to groundwater control, evaluation of existing pavements, proof-rolling, and maintaining client relations. Laboratory duties include testing of soils and concrete including; compression testing of concrete, proctors, concrete mix designs, and soil-cement mix designs.

2001 – May 2005 Construction Engineering Consultants. - Field Technician

Responsibilities: Construction materials testing and inspection including; compaction testing of soils, field concrete testing, asphalt testing, high strength bolted and welded connections inspection, masonry inspection, sprayed fireproofing inspection, sanitary and storm water system installation inspection, monitoring field quantities and work performed. Duties also included field verification of foundation bearing surfaces and pavement subgrade stability, inspection of deep foundations, construction related groundwater control and proof-rolling monitoring. Laboratory duties included laboratory testing of soils and concrete including; compression testing of concrete and proctors.

EDUCATION

B.A. – in Environmental Science - University of Pittsburgh - 2001

David L. Irvine

ACCREDITATIONS & CERTIFICATIONS

ACI Level I Concrete Field Testing Certification

Radiological Safety & Use of Nuclear Testing Equipment, Troxler Corporation

NICET level 1- Construction Materials Testing

NECEPT Concrete Field Testing Technician

AWS QC1 Certified Welding Inspector

PAUL C. Fiset, P.E.

Lab Manager/ Engineer

CAREER SUMMARY

Professional Engineer with several years of field experience transitioning within the past few years into the Lab Manager position. Career began as a field technician, responsible for documenting and monitoring jobsite activity. Responsibilities now progressed from predominantly field work to predominantly laboratory and office work. Office work mainly includes assistance in geotechnical design, and aiding in the preparation of proposals and reports. Laboratory work mainly includes managing the laboratory technicians, performing laboratory testing, reviewing laboratory test results, and continually maintaining our laboratory concrete and soil testing accreditations through proficiency sample testing and on-site assessments. Recently, soil-cement stabilization and full-depth reclamation mix designs have been of heavy focus for PennDOT and several private firms within the gas and oil industry.

PROFESSIONAL EXPERIENCE

March 2016 – Present Pennsylvania Soil & Rock, Inc. – Lab Manager/Engineer

Responsibilities: Continued with previous responsibilities as an Engineer below. In addition, managing, directing, and training the laboratory technicians, performing laboratory testing, reviewing and interpreting laboratory test results, and maintaining our laboratory accreditations through proficiency sample testing and on-site assessments with AASHTO and CCRL. Additionally, continuous coordinating between lab testing and the project managers to ensure deadlines are met.

October 2012 – March 2016 Pennsylvania Soil & Rock, Inc. – Engineer

Responsibilities: Serve as an on-site engineer, verifying construction practices and sequencing is properly implemented and documented. In addition, perform construction material testing and inspection, i.e. concrete testing and soil compaction testing; logging of boreholes during geotechnical drilling; infiltration testing; bearing capacity evaluations; and additional geotechnical field investigations. Assist in compiling preliminary geotechnical analysis reports with the aid of mining maps, wetlands map, soils maps, and other necessary resources; and assist with calculations and research for engineering designs, i.e. stormwater management runoff calculations.

Summer 2011 & March 2012 – October 2012 David Blackmore & Associates – Field Technician

Responsibilities: Performed on-site construction material testing, i.e. soil compaction and concrete testing. Documented daily site activities and verified site work was as specified by design.

EDUCATION

B.S. in Civil Engineering - The Pennsylvania State University, 2011

M.S. in Geotechnical Engineering – The University of Pittsburgh, 2018

ACCREDITATIONS & CERTIFICATIONS

Registered Professional Engineer, Pennsylvania 2019

Member – American Society of Civil Engineers (ASCE), 2009-Present

ACI Level I Concrete Field Testing Certification
Radiological Safety & Use of Nuclear Testing Equipment, Troxler Corporation
SafeLandUSA Training, 2014

ROBERT S. BECHTOLD
Senior Field Technician

CAREER SUMMARY

Experienced construction technician/field manager on several large industrial, commercial, highway and residential development projects. Experienced in all facets of construction over-site including construction observation, field documentation, material sampling and testing.

PROFESSIONAL EXPERIENCE

March 2012 – Current PENNSYLVANIA SOIL & ROCK, INC. - Senior Field Technician.

Responsibilities: Provide construction monitoring, documentation and testing on construction projects including earth embankments, various retaining walls, several types of building structures, utilities and roadways. Work includes oversight of all forms of structural fill monitoring including toe key evaluation, drainage and proper benching. Foundation works includes installation and testing foundations (i.e. Spread footings, drilled concrete piers/caissons, auger-cast piles, etc). Field testing procedures include field compaction testing of soils using a nuclear moisture-density gauge and fresh concrete testing (i.e. slump, temperature, air entrainment, test cylinder preparation, etc.).

March 1993 – March 2012 Jeff Zell Consultants, Inc., Professional Service Industries, Inc., Solar Testing Labs, Inc., ACA Engineering, Inc., and Site Blauvelt Engineers, Inc. - Construction Inspector/Construction Materials Inspector/Technician

Responsibilities: Provided inspection services, recorded information, verified PTC contract and established standards (PTM/AASHTO) for compliance of: Superpave and Marshall asphalt designing, production, shipment and placement; Concrete design, production, shipment and placement; Aggregate production, shipment and placement; Precast concrete product production through shipment and placement; Perform field placement inspection and testing of aggregates and soils; Perform field and plant sampling and testing of asphalt cores and box samples, concrete cylinders and cores, all types of aggregates, and soils for PTC contract compliance; Constantly supply appropriate materials assistance to All PTC, Consultant, or PTC Contractor/Supplier personnel at any time; Assure swift contractor/producer corrective action if in non-compliance and enforce the actions of the PTC to address non-compliance issues; Fluent in all PTC Construction Documentation System Materials (CDSMe) applications and interfacing with Constructware for proper PTC documentation.

April 1991 – September 1992 Electric M&R, Inc.- Assistant Plant Manager/Supervisor.

Responsibilities: Scheduled plant production/operations and conducted inside sales. Supervised union workers on industrial electric motor and driven systems remanufacture and parts manufacturing.

August 1989 – March 1991 F.M. Locotos Company, Inc. – Product Engineer

Responsibilities: Conducted product testing and new development of mine roof bolt support systems for major coal producers and construction firms.

EDUCATION

Bachelor of Science
Penn State University
State College, PA

Major: Mechanical Engineering

TRAINING/PROFESSIONAL CERTIFICATIONS

2002 NECEPT Asphalt Plant Technician- Level II (re-certified 2007,2012)
1999 NECEPT Asphalt Plant Superpave Technician
1998 NICET Level III, Construction Materials Testing, sub-field of asphalt
1998 NICET Level II, Highway Materials
1997 NECEPT Asphalt Plant Technician- Level I
1995 NICET Level II, Construction Materials Testing, sub-fields of asphalt, concrete, and soils
1994 FAA Asphalt Plant Technician/Inspector
1993 PennDOT Certified Asphalt and Soils Compaction and Concrete Field Technician
1993 ACI Level I Field Technician (re-certified 1998, 2002, 2008)
1993 Troxler Certified Field Technician (re-certified 1996)
All required NECEPT asphalt plant technician courses, the Pennsylvania Transportation Institute, State College, Pennsylvania, 1997 - Present
FAA Asphalt Plant Technician/Inspector Certification, Penn State University, March 1994
Certification of Construction Material Testing/Inspection, Jeff Zell Consultants, March 1993
+ 350 hours of field/lab testing, design, and application of soils, concretes, and asphalts for construction

Pennsylvania Soil and Rock Incorporated

3.0 Certificate of Insurance



CERTIFICATE OF LIABILITY INSURANCE

DATE (MM/DD/YYYY)

11/15/2022

THIS CERTIFICATE IS ISSUED AS A MATTER OF INFORMATION ONLY AND CONFERS NO RIGHTS UPON THE CERTIFICATE HOLDER. THIS CERTIFICATE DOES NOT AFFIRMATIVELY OR NEGATIVELY AMEND, EXTEND OR ALTER THE COVERAGE AFFORDED BY THE POLICIES BELOW. THIS CERTIFICATE OF INSURANCE DOES NOT CONSTITUTE A CONTRACT BETWEEN THE ISSUING INSURER(S), AUTHORIZED REPRESENTATIVE OR PRODUCER, AND THE CERTIFICATE HOLDER.

IMPORTANT: If the certificate holder is an ADDITIONAL INSURED, the policy(ies) must have ADDITIONAL INSURED provisions or be endorsed. If SUBROGATION IS WAIVED, subject to the terms and conditions of the policy, certain policies may require an endorsement. A statement on this certificate does not confer rights to the certificate holder in lieu of such endorsement(s).

PRODUCER	CONTACT NAME:
Affolder & Associates	PHONE (A/C, No., Ext.): (412) 366-9100
The Insurance Center	FAX (A/C, No.): (412) 369-2859
8700 Perry Highway	E-MAIL ADDRESS: joyce@affolderinsurance.com
Pittsburgh PA 15237	INSURER(S) AFFORDING COVERAGE
	INSURER A: Mutual Benefit Insurance
	INSURER B:
	INSURER C:
	INSURER D:
	INSURER E:
	INSURER F:

COVERAGES	CERTIFICATE NUMBER:	REVISION NUMBER:
THIS IS TO CERTIFY THAT THE POLICIES OF INSURANCE LISTED BELOW HAVE BEEN ISSUED TO THE INSURED NAMED ABOVE FOR THE POLICY PERIOD INDICATED. NOTWITHSTANDING ANY REQUIREMENT, TERM OR CONDITION OF ANY CONTRACT OR OTHER DOCUMENT WITH RESPECT TO WHICH THIS CERTIFICATE MAY BE ISSUED OR MAY PERTAIN, THE INSURANCE AFFORDED BY THE POLICIES DESCRIBED HEREIN IS SUBJECT TO ALL THE TERMS, EXCLUSIONS AND CONDITIONS OF SUCH POLICIES. LIMITS SHOWN MAY HAVE BEEN REDUCED BY PAID CLAIMS.		

INSR LTR	TYPE OF INSURANCE	ADDL SUBR INSD WVD	POLICY NUMBER	POLICY EFF (MM/DD/YYYY)	POLICY EXP (MM/DD/YYYY)	LIMITS
A	<input checked="" type="checkbox"/> COMMERCIAL GENERAL LIABILITY <input type="checkbox"/> CLAIMS-MADE <input checked="" type="checkbox"/> OCCUR GEN'L AGGREGATE LIMIT APPLIES PER: <input type="checkbox"/> POLICY <input checked="" type="checkbox"/> PRO-JECT <input type="checkbox"/> LOC <input type="checkbox"/> OTHER:		BU00923759	11/22/2022	11/22/2023	EACH OCCURRENCE \$ 1,000,000 DAMAGE TO RENTED PREMISES (Ea occurrence) \$ 300,000 MED EXP (Any one person) \$ 10,000 PERSONAL & ADV INJURY \$ 1,000,000 GENERAL AGGREGATE \$ 2,000,000 PRODUCTS - COMP/OP AGG \$ 2,000,000
A	<input checked="" type="checkbox"/> AUTOMOBILE LIABILITY <input checked="" type="checkbox"/> ANY AUTO <input checked="" type="checkbox"/> OWNED AUTOS ONLY <input type="checkbox"/> SCHEDULED AUTOS <input checked="" type="checkbox"/> HIRED AUTOS ONLY <input checked="" type="checkbox"/> NON-OWNED AUTOS ONLY		BA00923759	11/22/2022	11/22/2023	COMBINED SINGLE LIMIT (Ea accident) \$ 1,000,000 BODILY INJURY (Per person) \$ BODILY INJURY (Per accident) \$ PROPERTY DAMAGE (Per accident) \$
A	<input checked="" type="checkbox"/> UMBRELLA LIAB <input checked="" type="checkbox"/> OCCUR <input type="checkbox"/> EXCESS LIAB <input type="checkbox"/> CLAIMS-MADE <input type="checkbox"/> DED <input type="checkbox"/> RETENTION \$		UL00923759	11/22/2022	11/22/2023	EACH OCCURRENCE \$ 9,000,000 AGGREGATE \$ 9,000,000
A	WORKERS COMPENSATION AND EMPLOYERS' LIABILITY ANY PROPRIETOR/PARTNER/EXECUTIVE OFFICER/MEMBER EXCLUDED? (Mandatory in NH) <input type="checkbox"/> Y/N If yes, describe under DESCRIPTION OF OPERATIONS below	N/A	WC23923759	11/22/2022	11/22/2023	<input checked="" type="checkbox"/> PER STATUTE <input type="checkbox"/> OTH-ER E L EACH ACCIDENT \$ 1,000,000 E L DISEASE - EA EMPLOYEE \$ 1,000,000 E L DISEASE - POLICY LIMIT \$ 1,000,000
A	Inland Marine		IC00923759	11/22/2022	11/22/2023	Contractors Equip Scheduled

DESCRIPTION OF OPERATIONS / LOCATIONS / VEHICLES (ACORD 101, Additional Remarks Schedule, may be attached if more space is required)

For all work performed.

CERTIFICATE HOLDER	CANCELLATION
EVIDENCE OF COVERAGE	SHOULD ANY OF THE ABOVE DESCRIBED POLICIES BE CANCELLED BEFORE THE EXPIRATION DATE THEREOF, NOTICE WILL BE DELIVERED IN ACCORDANCE WITH THE POLICY PROVISIONS.
	AUTHORIZED REPRESENTATIVE <i>Joseph Lagan</i> <JG>

© 1988-2015 ACORD CORPORATION. All rights reserved.

Pennsylvania Soil and Rock Incorporated

4.0 Professional Services and Laboratory Testing Unit Rates

RATE SCHEDULE FOR PS&R LABORATORY SERVICES (January 2023)

SOILS

-PARTICLE SIZE ANALYSIS OF SOILS BY HYDROMETER OR SIEVE (ASTM D422)	\$95.00/TEST
-LIQUID AND PLASTIC LIMITS OF SOILS (ASTM D4318)	\$55.00/TEST
-MOISTURE DENSITY (PROCTOR) OF SOILS, STANDARD* (ASTM D698)	\$165.00/TEST
-MOISTURE DENSITY (PROCTOR) OF SOILS, MODIFIED* (ASTM D1557) * Add \$20 for Rock Content and Correction	\$185.00/TEST
-SPECIFIC GRAVITY OF SOILS (ASTM D854)	\$55.00/TEST
-AMOUNT OF MATERIAL FINER THAN NO. 200 SIEVE (ASTM D1140)	\$55.00/TEST
-MOISTURE CONTENT OF SOIL (ASTM D2216)	\$6.00/TEST
- DIRECT SHEAR	\$425.00/TEST
- SOIL-CEMENT/FDR PLUGS (PREP/COMPRESSION TEST)	\$40.00/PLUG

AGGREGATES

-MATERIAL FINER THAN NO.200 SIEVE (ASTM C117)	\$55.00/TEST
-SIEVE ANALYSIS OF AGGREGATES (ASTM C136)	\$55.00/TEST
-FINE AGGREGATE SPECIFIC GRAVITY AND ABSORPTION (ASTM D128)	\$55.00/TEST
-COARSE AGGREGATE SPECIFIC GRAVITY AND ABSORPTION (ASTM D127)	\$55.00/TEST

CONCRETE

- COMPRESSIVE STRENGTH OF CYLINDRICAL CONCRETE SPECIMENS (ASTM C39)	\$19.25/TEST
--	--------------

RATE SCHEDULE FOR PS&R SERVICES (EFFECTIVE January 2023)

PROFESSIONAL ENGINEER (P.E.)/PROJECT MANAGER	\$137.00/HR
PROFESSIONAL LAND SURVEYOR (P.L.S.)	\$137.00/HR
PROFESSIONAL GEOLOGIST (P.G.)	\$125.00/HR
WETLAND/PLANT SPECIALIST	\$100.00/HR
SENIOR ENGINEER/GEOLOGIST	\$100.00/HR
BOTANIST	\$ 90.00/HR
DRILLING MONITOR/FIELD MANAGER/ENGINEER/GEOLOGIST	\$ 90.00/HR
SURVEYOR	\$ 90.00/HR
STRUCTURAL STEEL TECHNICIAN	\$ 82.50/HR
GIS SPECIALIST	\$ 75.00/HR
ENVIRONMENTAL SCIENTIST	\$ 65.00/HR
WETLAND TECHNICIAN	\$ 60.00/HR
CONSTRUCTION/SURVEY/FIELD TECHNICIAN	\$ 57.50/HR
CADD DRAFTSMAN	\$ 57.50/HR
CLERICAL	\$ 43.00/HR

EQUIPMENT RENTALS, EXPENSES & LABORATORY TESTS:

NUCLEAR DENSOMETER (Compaction)	\$ 55/DAY
SURVEY EQUIPMENT	\$ 50/HR
4-WHEEL DRIVE TRUCK (PS&R) (or \$0.65 PER MILE-Whichever is greater)	\$ 75/DAY
PERSONAL AUTO/TRUCK (MINIMUM) (or \$0.585 PER MILE-Whichever is greater)	\$ 20/DAY
MISC EXPENSES (Tolls, Lodging, Postage, Supplies, Materials, Advancement of Fees, etc)	Cost plus 10%
B/W COPIES (8.5X11)	\$ 0.05/Copy
COLOR COPIES (8.5X11)	\$ 1.00/Copy
LARGE FORMAT DWGS	\$ 0.25/SF

9

APPOINTMENT: TESTING AND BALANCING AGENT

AS PART OF THE CONSTRUCTION, THE BUILDING'S HVAC SYSTEMS MUST BE TESTED AND BALANCED.

PROPOSALS WERE RECEIVED FROM NORTHSTAR ENVIRONMENTAL, LTD AND WAE BALANCING, INC., AND THEIR PROPOSALS AND BID TABULATION IS ATTACHED.

WHAT ACTION DOES THE BOARD WISH TO TAKE.

I MOVE TO APPOINT WAE BALANCING, INC. AS THE TESTING AND BALANCING AGENT FOR THE NEW MUNICIPAL BUILDING PROJECT AT A COST OF \$11,450.00 AS PROPOSED.

	MOTION	SECOND	AYES	NAYES
MR. SMULLIN	—	—	—	—
MR. FREY	—	—	—	—
MR. HARRISON	—	—	—	—
MRS. HOLLIBAUGH	—	—	—	—
MRS. JORDAN	—	—	—	—

April 12, 2023



Northstar Environmental, Ltd.
an independent flow measurement agency



PROJECT: West Deer Municipal

PROPOSAL # 0411235	Date: 04/11/2023
AIR SYSTEMS TAB	\$10,080.00
HYDRONIC SYSTEMS TAB	\$4,640.00
RESISTANCE HEATING ELEMENT	N/A
SOUND TESTING	N/A
VIBRATION TESTING	N/A
DALT (PRICE IS PASS OR FAIL)	N/A
IAQ / VOC TESTING	N/A
HOIST-WAY PRESSURIZATION TESTING	N/A
STAIRWELL PRESSURIZATION TESTING	N/A
PRE-CONSTRUCTION TESTING	N/A
Fume Hood Performance Testing to	Excluded
ALT	N/A
ALT	N/A
ALT	N/A
TOTAL:	\$14720.00

Exclusions

Seasonal Testing, Refrigerant Testing, ASHRAE 110 Testing, Any lifts, scaffolds or other apparatus that may be required to perform the TAB that cannot be safely performed from an 8 foot step ladder. Training or instruction. DDC components software or interface to communicate with HVAC systems.

Special note: Sulfur Hexafluoride the primary gas for performing ASHRAE110 has been deemed too harmful to the atmosphere to continue to use. ASHRAE currently is evaluating other gases as well as solutions. Additionally the lone manufacturer of the lone analyzer for this tracer gas no longer services or calibrates the equipment. Northstar can no longer offer this service nor can anyone else until ASHRAE comes up with a solution.

Conditions

This proposal is for a single mobilization unless stated otherwise above and this proposal becomes void 30 calendar days after the date above.

WAE BALANCING, INC.



15 Tripplewood Drive – Mercer, PA 16137
Phone: (724) 662-5743
FAX: (724) 662-1729
wae@waebalancing.com

April 10, 2023

Attention: Estimating

Project: **West Deer Municipal Building**

Gentlemen:

We are pleased to provide you with the following quotation for the above referenced project:

AIR BALANCE: \$7,300.00

WATER BALANCE: \$2,150.00

COMMISSIONING ASSISTANCE: \$2,000.00

Total: \$11,450.00

The above quotation does not include:

- 1) The purchase or installation of air filters.
- 2) Necessary changes in sheaves and/or belts.
- 3) The installation or cost of necessary dampers required to provide air balancing.
- 4) The installation or cost of necessary balancing cocks, gauges or meters for balancing systems.
- 5) VAV/FPB calibration of no more than 2 points. (zero and max)
- 6) EXCLUDES duct leakage pricing unless otherwise noted.
- 7) EXCLUDES ASHRAE 110 & SEFA 1.2-1996 Tests of Fume Hoods, unless otherwise noted.
- 8) EXCLUDES Pre-Construction pricing unless otherwise noted.
- 9) EXCLUDES Commissioning Assistance/Presence pricing unless otherwise noted.

Prices are good for 90 days from bid date and assume normal day light working hours, unless otherwise stated.

Respectfully,

Bruce Wamboldt

WAE Balancing, Inc.

10

AUTHORIZATION: DUQUESNE LIGHT TEMPORARY AND PERMANENT SERVICE

DURING THE CONSTRUCTION THE BUILDING WILL NEED TEMPORARY POWER. PERMANENT POWER INSTALLATION IS ALSO REQUIRED UNDER A SEPARATE WORK ORDER.

DUQUESNE LIGHT IS THE ELECTRIC PROVIDER, AND PROVIDED THE ATTACHED DRAWINGS AND WORK ORDER NUMBERS/COSTS.

WO#984745 – TEMPORARY SERVICE - \$2,693.95

WO#957923 – PERMANENT SERVICE - \$28,589.11

WHAT ACTION DOES THE BOARD WISH TO TAKE.

I MOVE TO AUTHORIZE THE TOWNSHIP MANAGER TO EXECUTE THE TEMPORARY AND PERMANENT WORK ORDERS FOR DUQUESNE LIGHT TO PROVIDE TEMPORARY AND PERMANENT SERVICE TO THE NEW MUNICIPAL BUILDING PROJECT AT A COST OF \$2,693.95 FOR THE TEMPORARY SERVICE AND 428,589.11 FOR THE PERMANENT SERVICE.

	MOTION	SECOND	AYES	NAYES
MR. FREY	_____	_____	_____	_____
MR. HARRISON	_____	_____	_____	_____
MRS. HOLLIBAUGH	_____	_____	_____	_____
MR. SMULLIN	_____	_____	_____	_____
MRS. JORDAN	_____	_____	_____	_____

TEMP

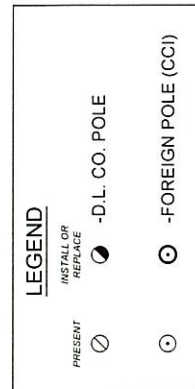
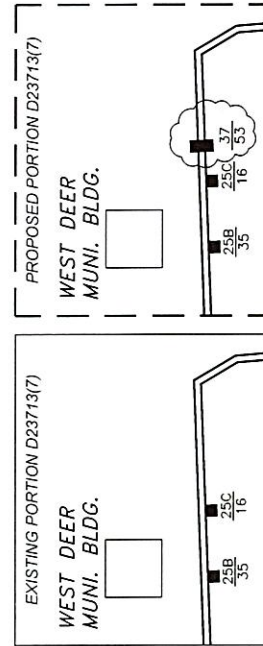
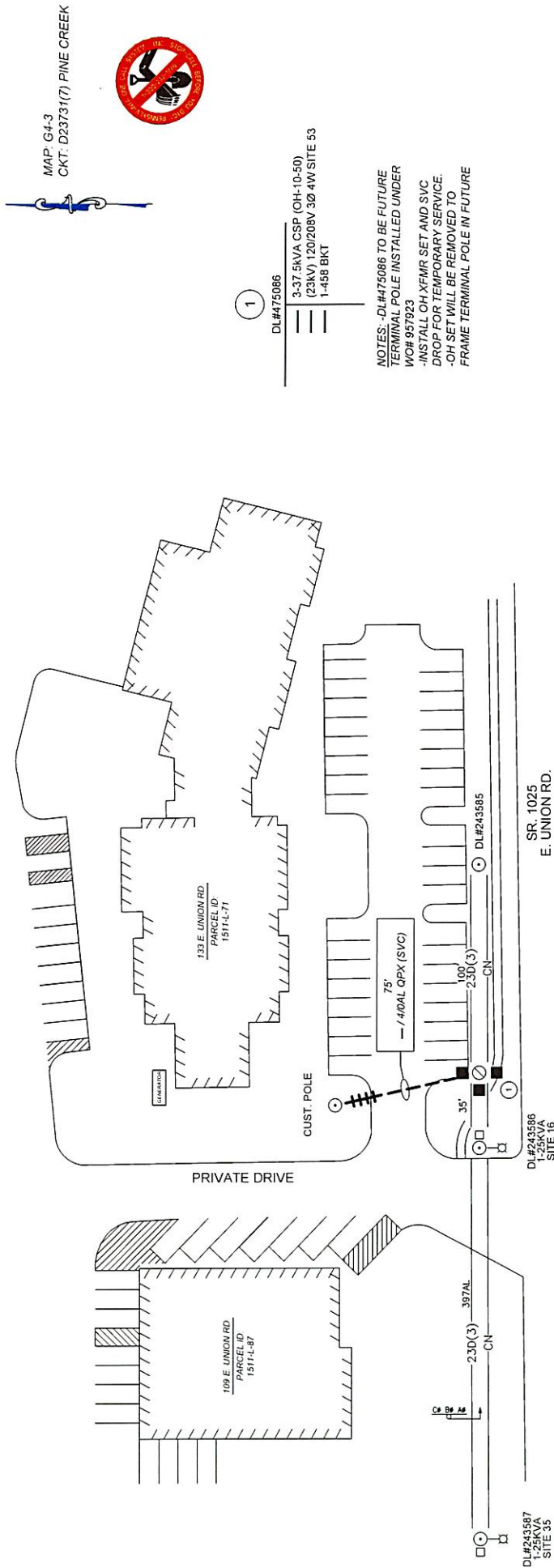

DUQUESNE LIGHT CO.				DISTRIBUTION ENGINEERING		NEW BUSINESS - WEST DEER MUNI BLDG TEMP SVC	
AS-152KED_CH-B	DATE	DATE	SCALE	DATE	DATE	133 E. UNION RD. CHESWICK, 15024	WEST DEET TWP.
DATE	N.T.S.	04/17/2023	DATE	04/26/2023	04/26/2023	CONSTRUCTION DETAIL & MAP UPDATE	INSTALL FACILITIES FOR 120/208V 3Ø 4W TEMP SVC
DRAWN BY J. NEWCOMER				DATE	DATE	FW NO. 20-0105	FW NO. 984745
DATE				DATE	DATE	B	984745

REV. 0

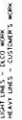
[illegible][illegible]

1. INSTALL 1" - 222" VIA DISTRIBUTION TRANSFORMER(S) CONNECTED TO THE 240VAC SUPPLY. (SEE 4 WIRE CONNECTIONS)
2. INSTALL TWO 500 MM COW CORPERS. CABLE (4 WIRE SERVICES) OR ONE 4" CORPERS FOR (2 OR 3 WIRE SERVICES) FROM THE H X TRANSFORMER TERMINAL TO THE GROUND BUS. BOTH WITH TWO 1/2" SAECON BRONZE BOLTS AT EACH CONNECTION.
3. IF THE TRANSFORMER IS EQUIPPED WITH A SEPARATE N. BUSHING, INSTALL A 4/0 STRANDED BASE CORPERS WITH FROM N. SPACE TO GROUND BUS.
4. INSTALL PRIMARY CABLES FROM THE DESIGNATED SUPPLY POINT TO THE TRANSFORMER AND CONNECT TO THE PRIMARY TERMINALS.

[illegible]

- A) NO BACKFILLING SHALL BEGUN UNTIL THE PRIMARY ELECTRICAL INSTALLATION HAS BEEN INSPECTED AND APPROVED BY SOG/SAFE COMPANY.
- B) BACKFILL WITH EARTH AND COMPACT (BACKFILL SHALL CONTAIN ROCKS, STONES ETC. OVER 2" IN DIAMETER).
- C) INSTALL ELECTRICAL WARNING TAPE ABOVE CONDUIT.
- D) INSTALL ONE 1-1/2" PVC SCHEDULE 40 CONDUIT FROM THE SECOND DECK TO THE FIRST DECK. THE CONDUIT SHALL BE LOCATED TO THE LEFT OF THE PAD ORIENTING TO THE METER LOCATION. CONDUIT TO LEAVE THE FIRST DECK TO THE SECOND DECK.

- A) NO BACKFILLING SHALL BEGUN UNTIL THE PRIMARY ELECTRICAL INSTALLATION HAS BEEN INSPECTED AND APPROVED BY SOG/SAFE COMPANY.
- B) BACKFILL WITH EARTH AND COMPACT (BACKFILL SHALL CONTAIN ROCKS, STONES ETC. OVER 2" IN DIAMETER).
- C) INSTALL ELECTRICAL WARNING TAPE ABOVE CONDUIT.
- D) INSTALL ONE 1-1/2" PVC SCHEDULE 40 CONDUIT FROM THE SECOND DECK TO THE FIRST DECK. THE CONDUIT SHALL BE LOCATED TO THE LEFT OF THE PAD ORIENTING TO THE METER LOCATION. CONDUIT TO LEAVE THE FIRST DECK TO THE SECOND DECK.

7923-11 - CONSTRUCTION DETAILS, CUSTOMER CONSULT PLAN

6 - WEST DEER TWP MUNI. BLDG SVC
RD. CHESWICK, 15024 WEST DEER TWP
SECTION DETAILS & ELECTRICAL LAYOUT
R'S PRECAST 275 KVA TRANSFORMER PAD
-0005 957923-12 0

1

1

OTHER BUSINESS

12

ADJOURNMENT

I MOVE TO ADJOURN AT _____ P.M.

	MOTION	SECOND	AYES	NAYES
MRS. HOLLIBAUGH	_____	_____	_____	_____
MR. SMULLIN	_____	_____	_____	_____
MR. FREY	_____	_____	_____	_____
MR. HARRISON	_____	_____	_____	_____
MRS. JORDAN	_____	_____	_____	_____