

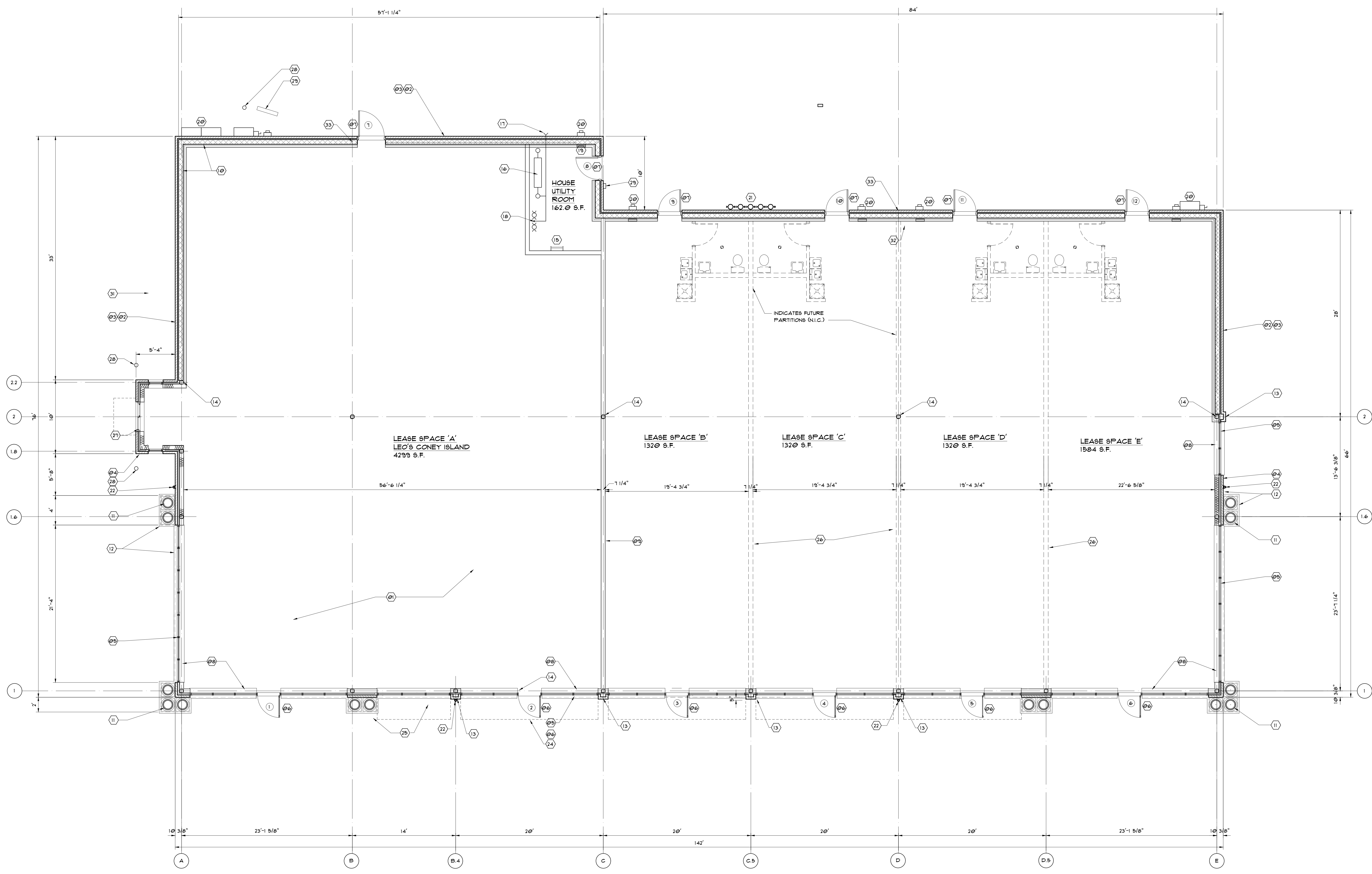

FLOOR PLAN KEY NOTES

- 01 4" REINFORCED CONCRETE FLOOR SLAB ON RADON / VAPOR BARRIER ON MINIMUM 4" COMPACTED GRANULAR FILL.
- 02 4" BRICK VENEER ON 8" C.M.U. W/ #5 @ 24" O.C. & HORIZONTAL JOINT REINFORCING @ 16" O.C.
- 03 FILL OPEN CORES IN C.M.U. WITH POLYURETHANE SPRAY FOAM INSULATION.
- 04 4" BRICK VENEER ON AIR SPACE ON RIGID INSULATION (R-3.4) ON M.R.B. ON 5/8" EXTERIOR SHEATHING ON 18 GAGE, 6-INCH METAL STUDS @ 24" O.C.
- 05 INDICATES STOREFRONT GLAZING SYSTEM: 1" INSULATED GLASS IN 2" x 4 1/2" PAINTED ALUMINUM FRAMES.
- 06 INDICATES 3' x 7' GLASS AND ALUMINUM DOOR.
- 07 INDICATES HOLLOW METAL DOOR & FRAME, PAINT DOOR & FRAME, REFER TO DOOR SCHEDULE.
- 08 SOLID SURFACE BILL & AFFRON - TYPICAL.
- 09 DEMISING PARTITION - REFER TO WALL SECTIONS.
- 10 INTERIOR SURFACE: 5/8" GYPSUM BOARD ON 2 1/2" METAL STUDS @ 24" O.C. ON R-13 CONTINUOUS INSULATION (2 1/2" THICK FOR PLAN DIMENSIONING).
- 11 INDICATES 16" DIAMETER TUSCAN COLUMNS.
- 12 5" LIMESTONE WATERTABLE.
- 13 BRICK PIER.
- 14 6" x 6" STEEL TUBE COLUMNS - TYP.
- 15 ROOF LADDER.
- 16 FIRE SUPPRESSION RISER.
- 17 FIRE DEPARTMENT CONNECTION.
- 18 WATER METER RISER - REFER TO PLUMBING PLANS.
- 19 HOUSE POWER PANEL - REFER TO ELECTRICAL DRAWINGS.
- 20 ELECTRICAL SERVICE EQUIPMENT - REFER TO ELECTRICAL DRAWINGS.
- 21 GAS METERS - REFER TO PLUMBING DRAWINGS.
- 22 PRE-FINISHED METAL DOWNSPOUT - REFER TO PLUMBING DRAWINGS.
- 23 NOT USED.
- 24 SHORT DASH LINE INDICATES FABRIC AWNING ABOVE.
- 25 NOT USED.
- 26 INDICATES FUTURE DEMISING PARTITION - EXACT LOCATION TO BE VERIFIED (N.I.C.).
- 27 DRIVE THRU WINDOW - REFER TO PROJECT MANUAL.
- 28 6" DIAMETER, CONCRETE FILLED PIPE BOLLARD W/ PVC COVER; COLOR TO BE SELECTED.
- 29 KNOX BOX.
- 30 TENANT'S MENU BOARD & SPEAKER POST (BY TENANT); FOUNDATION POWER & DATA CONDUITS BY G.C.
- 31 NOT USED.
- 32 LANDSCAPE AREA, REFER TO LANDSCAPE DRAWINGS.
- 33 ROOF VERTICAL STORM LEADER - REFER TO PLUMBING DRAWINGS.
- 34 MASONRY CONTROL JOINT REFER TO DETAIL #10 / 5-5.1.



FLOOR PLAN SCALE: 3/16" = 1'-0" GRAPHIC SCALE 0 1 4 8 16 10,000.0 SQUARE FEET, FULLY SPRINKLED; TYPE II-B CONSTRUCTION.

C:\Users\mray\OneDrive\Documents\21-06\21-06 DWG\A-3.1.dwg, A-3.1, 2/5/2024, 11:41:37 AM, AutoCAD PDF (General Documentation).pc3, ARCH full bleed ET (80.00 x 42.00 inches), 1:1