



**COLOR KEY**

- RED
- ORANGE
- GREEN
- OLIVE
- LIME
- OCEAN
- AQUA
- CHARCOAL
- GRAY
- GRANITE
- BROWN
- TAN
- BLACK
- E RED/WHITE
- E ORANGE/BLACK
- E OLIVE/BLACK
- E OCEAN/BLACK
- E GRAY/BLACK
- E BLACK/GRAY









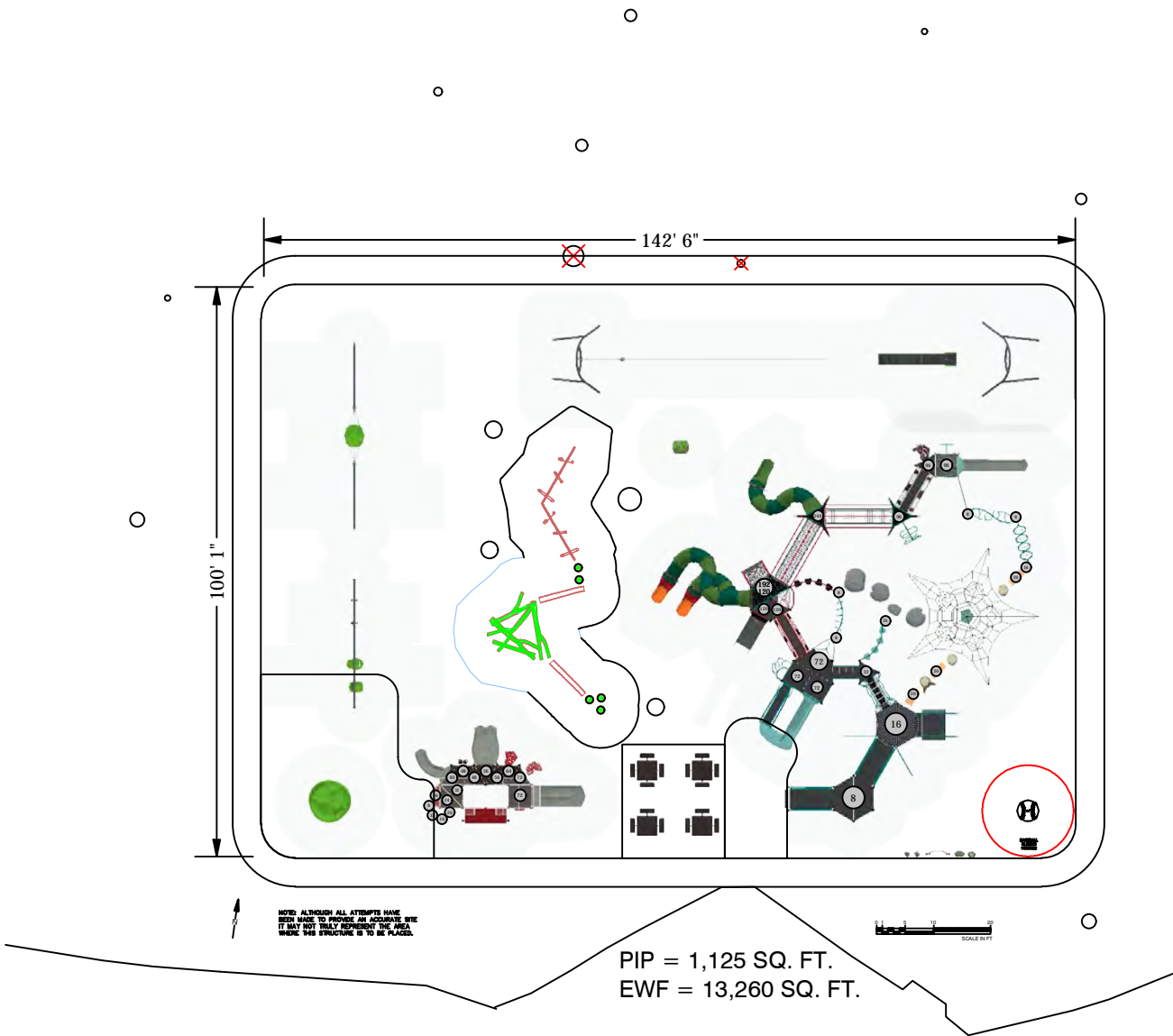

PIP = 1,125 SQ. FT.  
 EWF = 13,260 SQ. FT.

SERIES LINE: Burke Basics | Nucleus | Intensity

GROUP:  
 5-12 Structure | 2-5 Structure | PlayEnsemble | Freestanding  
 DESIGNED FOR AGES:  
 5 to 12, 2 to 5, 2 to 12

SITE PLAN VIEW

Viroqua - Eckhart Park  
 Viroqua, WI 54665

**Burke**  
 PLAY THAT MOVES YOU

Lee Recreation, LLC  
 142-196560-8

Designer: Kristin La Cross

BCI BURKE COMPANY, LLC | PO BOX 549 FOND DU LAC, WI 54938-0549 | 920.921.9220 | BCI BURKE.COM

OVERALL BOUNDING OF USE ZONES  
 Area: 14251.1 sq.ft.  
 Perimeter: 485 ft.  
 STRUCTURE SIZE: 100' 1"x142' 6"  
 POST SIZE(S): 5"

\*\*The space requirements shown here are to ASTM standards. Requirements for other standards may be different.

PLAYGROUND ACCESSIBILITY (Provided/Required)					
TOTAL EVENTS	ELEVATED EVENTS	TRANSFER ACCESSIBLE EVENTS	RAMP ACCESSIBLE EVENTS	GROUND EVENTS	TYPES OF GROUND EVENTS
87	41 / 21	22 / 10	9 / 11	45 / 14	14 / 5

The use and layout of play components identified in this plan conform to the CPSC guidelines. U.S. CPSC recommends the separation of age groups in playground layouts.

Warning: Accessible safety surfacing material is required beneath and around this equipment that is compliant with ASTM, CPSC, and ADAAG requirements.

# LEER LEE RECREATION, LLC

*Providing Fun Across Wisconsin Since 1995*

DATE: August 25, 2025  
 TO: Viroqua Parks  
 124 W. Decker St.  
 Viroqua, WI 54665  
 FROM: Pat Groom  
 RE: **Playground Proposal #142-196560-8**

## BCI BURKE "Play That Moves You"

Playground Proposal #142-196560-8  
 98 Play Events for an estimated 534 users ages 2-12

<p>1-#NUCLEUS                    Modular Structure, 5-12  <b>DECKS:</b> 6-Triangle, 3- Square, 2-Hexagonal, 3-Half Hexagon  <b>RAMP:</b> 1-ADAAG Ramp w/ Guardrail, 1-ADAAG Entrance Ramp w/ Guardrail  <b>BRIDGE:</b> Evolution Arched Catwalk Bridge  <b>TUNNEL:</b> 2-Aspire Rope Tunnels  <b>SLIDES:</b> Cobra Slide Curved @ 120" Deck Ht., Cobra Slide Curved @ 192" Deck Ht.,                       Velo XL Slide @ 96" Deck Ht., 360 Loop w/ Slide @ 72" Deck Ht.,                       Cobra Slide Curved @ 144" Deck Ht.  <b>ROOFS:</b> 3-Evolution Triangle Apex Roofs, 2-Triangle Base Roofs, 1-Clubhouse Retreat Roof  <b>UPPERBODY:</b> 1-Straight Overhead, 1-'S' Horizontal Ladder  <b>MOTION:</b> Innova Rocker, Niche Capsule Nano  <b>CLIMBERS:</b> Linx Levitate, Evolution 360 Inclusive Climber, Pursuit Climber, Victory Climber,                       Formis Ladder, Twisting Traverse, Tree Branch Climber, Verve Climber,                       Evolution Deck to Roof Climber, Shasta Climber, Snake Climber, Nucleus Core Climber,                       Mesa Climber, Ion Climber, Taktiks Curved Step Link, Rope Triangle Climber,                       Nature Play Sloped Log Climber, Nature Play Horizontal Split Log Climber,                       RopeVenture Sky5  <b>BALANCE/CLIMBING/SOCIAL:</b> 6-Ovistep Launch Pads, 3-Nature Play Stumps (2-Small, 1-Large),                       4-Nature Play Rocks (1-Small, 1-Large, 2-Medium),  <b>PLAY/ACTIVITY/PANELS:</b> Clubhouse Stanchion, Clubhouse Offset Enclosure,                       Clubhouse Unitary Enclosure, Jet Panel, 3-in-A-Row Panel, Bee Panel, Hide-the-Numbers,                       Rain Wheel, Seek 'N Find Panel, Rocket Cone, Seek 'N Find, Signing Panel,                       Custom Overhead Welcome Sign, Piston Panel, Pinball Panel, Rain Wheel Panel,                       6-Posted Mounted Spinners (Dots, Petals, Waves, Radiate, Spokes Pinwheel)</p>	<p>\$365,412.00</p>
<p>1-#NUCLEUS                    Modular Structure, 2-5  <b>DECKS:</b> 7-Triangle, 1-Square, 1-Crescent, 1-Split Square  <b>SLIDES:</b> Luge Slide @ 56" Deck Ht., Monaco Slide @ 40" Deck Ht., Contour Slide @ 72" Deck Ht.  <b>CLIMBERS:</b> Leaf Climber, Formis Ladder, Tree Branch Climber, Shasta Climber, Petal Step Climber  <b>ROOFS:</b> 2-Modern Curved Roofs  <b>BALANCE/CLIMBING/SOCIAL:</b> 4-Lil Novo Bean Step  <b>PLAY/ACTIVITY/PANELS:</b> Custom General Store Front, Panel w/ Counter, 2-Custom Panels</p>	<p>\$ 69,009.00</p>
<p>1-#MUSIC                        PlayEnsemble Music Station  <b>INCLUDES:</b> 1-FlowerGarden Poppy, 1-FlowerGarden Cosmo,                       1-PlayEnsemble Bongo Set, 1-Babel Drum, 1-Titan Chimes Hue</p>	<p>\$ 13,724.00</p>
<p>1-#SWINGS                      2-Bay - Single Post Swing Assembly  <b>INCLUDES:</b> 2-Tot Swing Seats, 1-Freedom Swing Seat, 1-Konnections Swing</p>	<p>\$ 6,341.00</p>
<p>1-#SWINGS                      3-Bay - Single Post Swing Assembly  <b>INCLUDES:</b> 4-Belt Swing Seats, 1-Cirrus</p>	<p>\$ 11,522.00</p>

# LEE RECREATION, LLC

*Providing Fun Across Wisconsin Since 1995*

1-#550-0206	ZipVenture		\$ 19,031.00
1-#560-0073	Nido Spinner		\$ 4,250.00
1-#560-2579	Volta Inclusive Spinner w/ Footer		\$ 8,429.00
2-#580-1393	Square Pedestal Tables	\$2,071 ea.	\$ 4,142.00
2-#580-1394	Square ADA Pedestal Table, 3 seats	\$1,735 ea.	\$ 3,470.00

## Cre8Play

1-#1000022	Baseball Climber		\$ 4,645.00
------------	------------------	--	-------------

## WholeTrees

1-#CLIMB-PLAY	WholeTrees Climbing & Play		\$ 59,800.00
---------------	----------------------------	--	--------------

**INCLUDES:** 1-Five Log Log Pile, 5-Log Steppers, 2-Rope Courses, 2-Fixed Balance Beams

Subtotal Equipment	\$569,775.00
Additional Discount	(\$ 81,780.00)
Assembly/Installation	\$167,555.00
Surfacing	\$ 42,450.00
Freight	<u>\$ 2,000.00</u>
<b>TOTAL</b>	<b>\$700,000.00</b>

### SURFACING NOTES:

- 1) 573 yd<sup>3</sup> Engineered Wood Fiber Surfacing Delivered Only - @ **\$14,325.00**
- 2) 1,125 ft<sup>2</sup> Playbound (™) Poured-In-Place Surfacing - @ **\$28,125.00**
  - Consists of a 50% Color – 50% Black speckled mix.
  - 24-hour security of site until product sets is the responsibility of the customer.

Quote Accepted by: \_\_\_\_\_ Date: \_\_\_\_\_

**Terms:** Net 20

**Marking of Private Lines, Site Preparation, Disposal of Garbage, Security of the Site Until Surfacing Sets & Site Restoration is the responsibility of the customer.**

**Lead time:** 10-12 Weeks Upon Receipt of Order

**Quote Effective:** **Until 09-25-2025**